

MORTAR & GROUT GUN - OPERATING INSTRUCTIONS

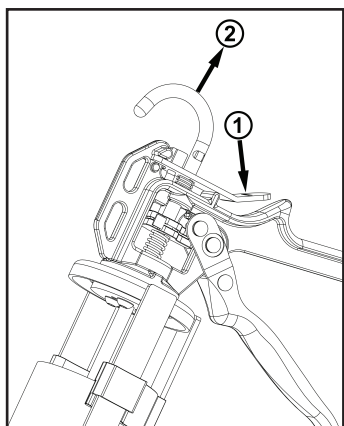

LOADING THE DISPENSER:

- 1 & 2. Depress the recoil and pull the rod completely back.
3. Remove the barrel.
4. Attach the appropriate nozzle.
5. Trowel your mortar or grout mix into the barrel.
6. Tap the side of the barrel to remove voids in the mix.
7. Replace the barrel into the gun.

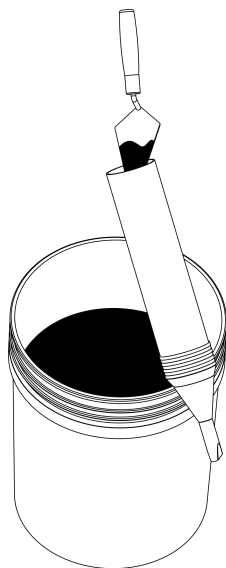

PLUNGER ADJUSTMENT:

The plunger is adjustable for wear. Tightening the nuts will squeeze the rubber to tighten its fit in the barrel.

NOTE: If the plunger is difficult to move even when wet it may be overtightened. Loosening the nuts will help.

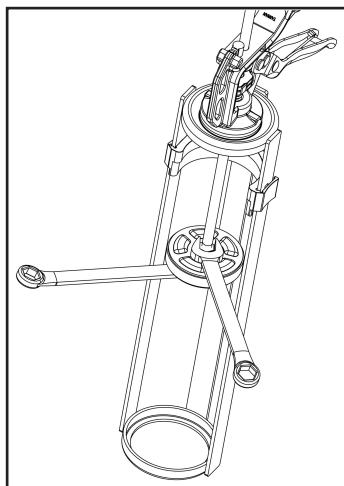

NOTE: The finer the aggregate in the mortar or grout, the easier it will be to dispense. Coarse aggregates may not dispense at all. Polymer (latex or "milk") modified grouts and mortars will dispense much more smoothly and consistently than straight sand / cement / lime mixtures. When using a cement-based mortar or grout you may need to modify your mix slightly for dispensing by gun. A wetter mix flows better, but too wet and you can get separation of the water and aggregate inside the barrel. Users have reported similar benefits from the addition of liquid dish soap to the mix. Clean the barrel after use with water.



Visit our **DISPENSING SOLUTIONS YOUTUBE CHANNEL** for Albion Instructional Videos on how to use and maintain your tools. <https://albioneng.com/product-resources-videos>

Questions? Call (856) 235-6688 or email service@albioneng.com