

## 10:1 SET-UP(750/75ML)

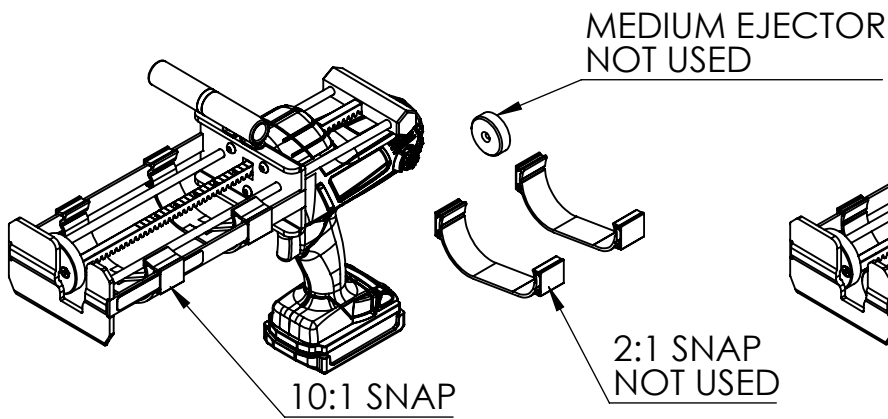

## 2:1 SET-UP(600/300ML)

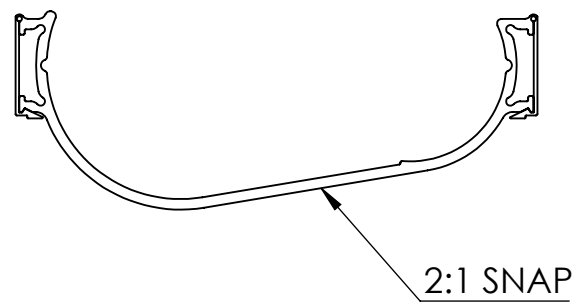
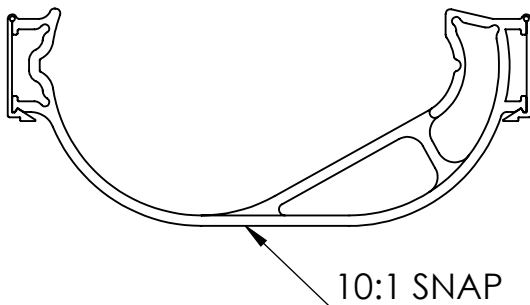
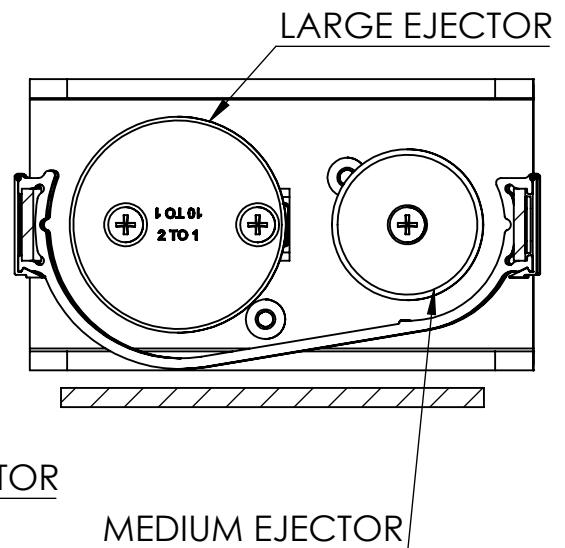
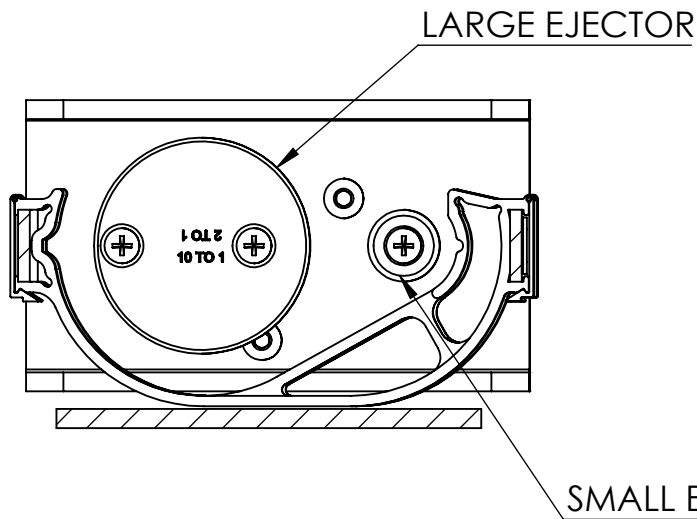
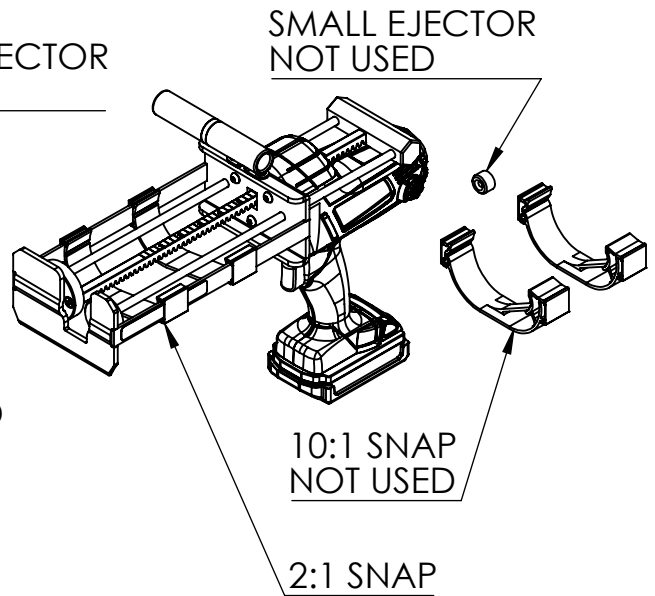

LARGE EJECTOR IS USED FOR BOTH SET-UPS. FLIP EJECTOR TO CORRECT POSITION FOR USE WITH EITHER 750/75ML OR 600/300ML CARTRIDGES. EJECTORS SHOULD BE CONCENTRIC WITH INSIDE OF STRAP WHEN PROPERLY INSTALLED.